

Overdenture Chairside Technique with Super Snap

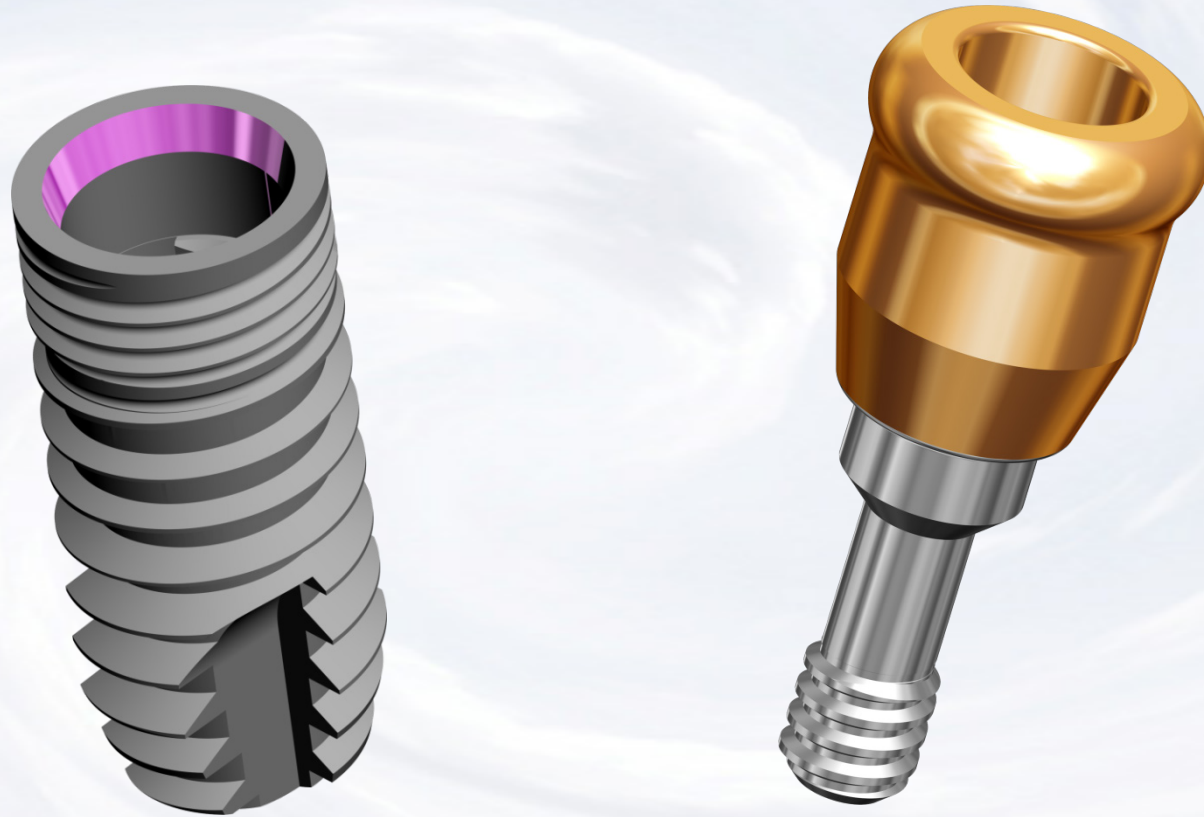

Blue Sky Bio

Overdenture Chairside Technique with Super Snap

Assemble screw driver with
Thumb Knob

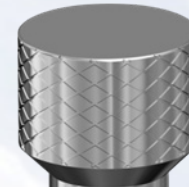

Remove healing abutment
from implant

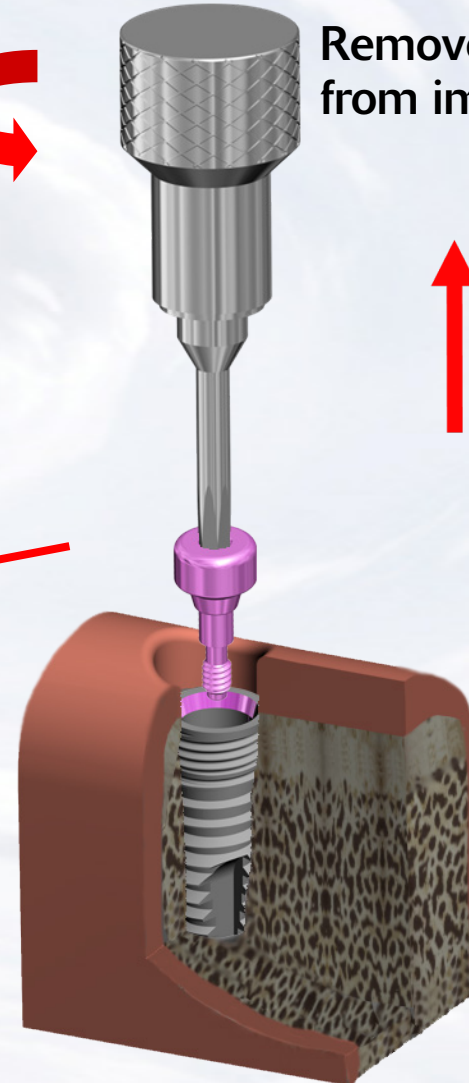
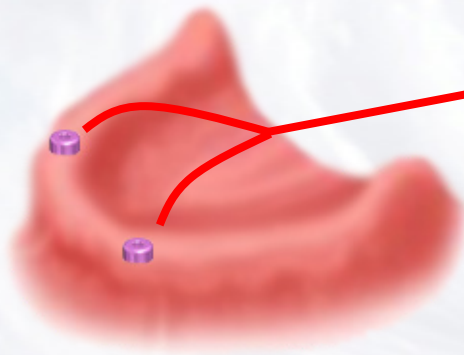

Blue Sky Bio

Overdenture Chairside Technique with Super Snap

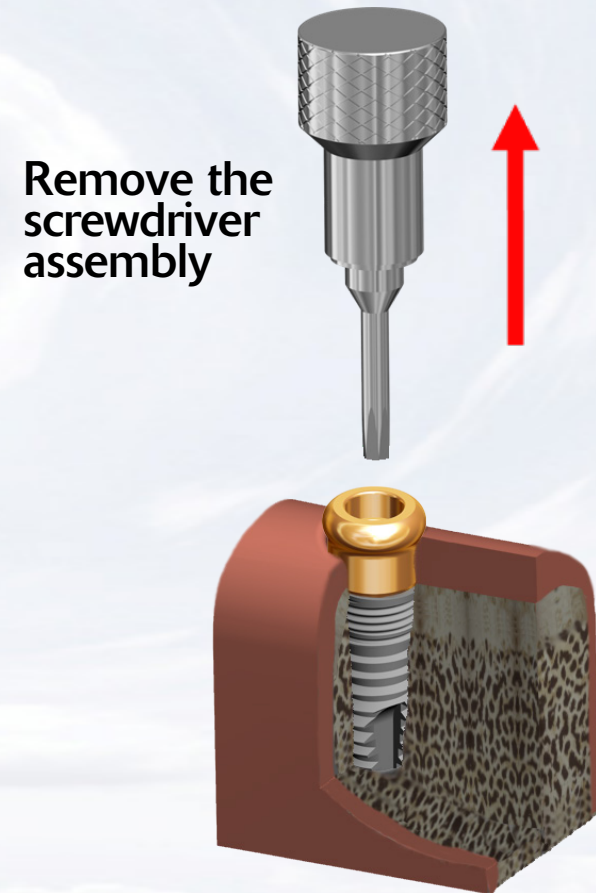
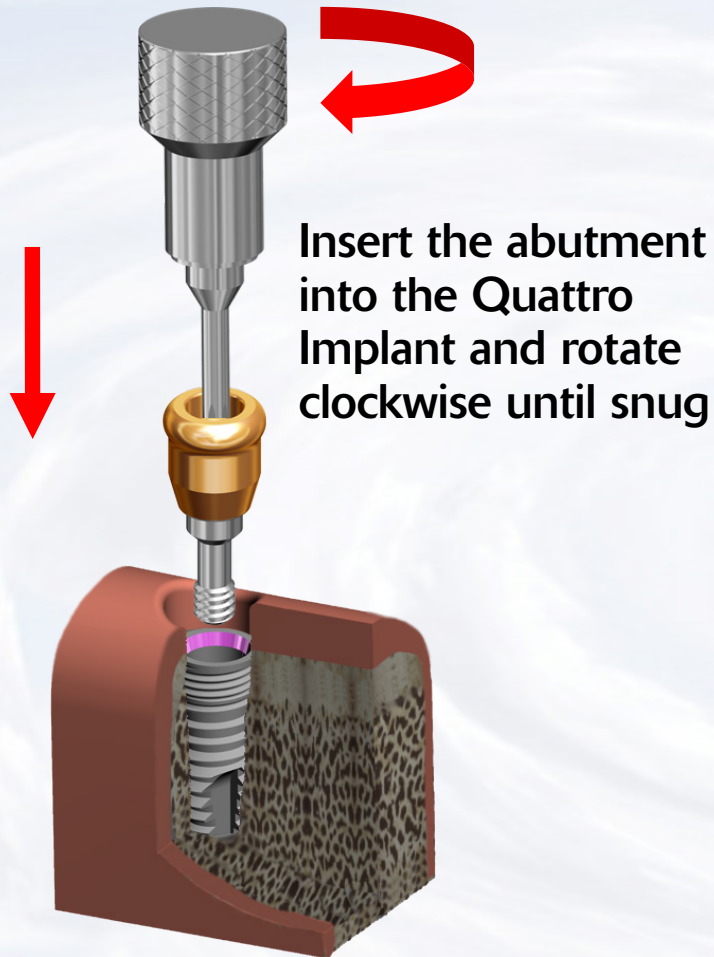

Blue Sky Bio

Overdenture Chairside Technique with Super Snap



Insert the Hex Driver within the 30Ncm torque ratchet

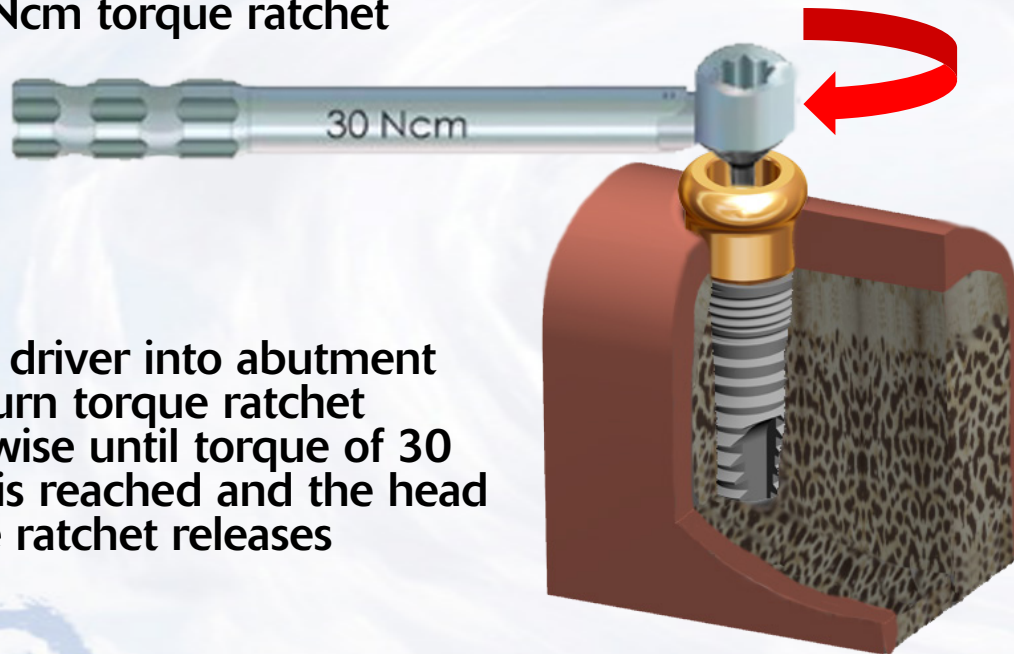

Insert driver into abutment and turn torque ratchet clockwise until torque of 30 Ncm is reached and the head of the ratchet releases

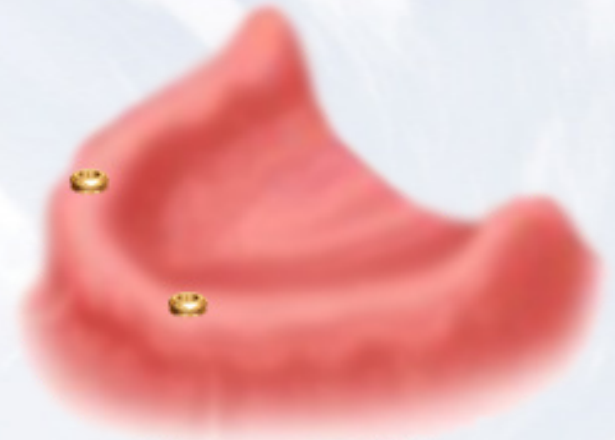

Abutments in place



Blue Sky Bio

Overdenture Chairside Technique with Super Snap

Put silicon blackout
ring on the abutment

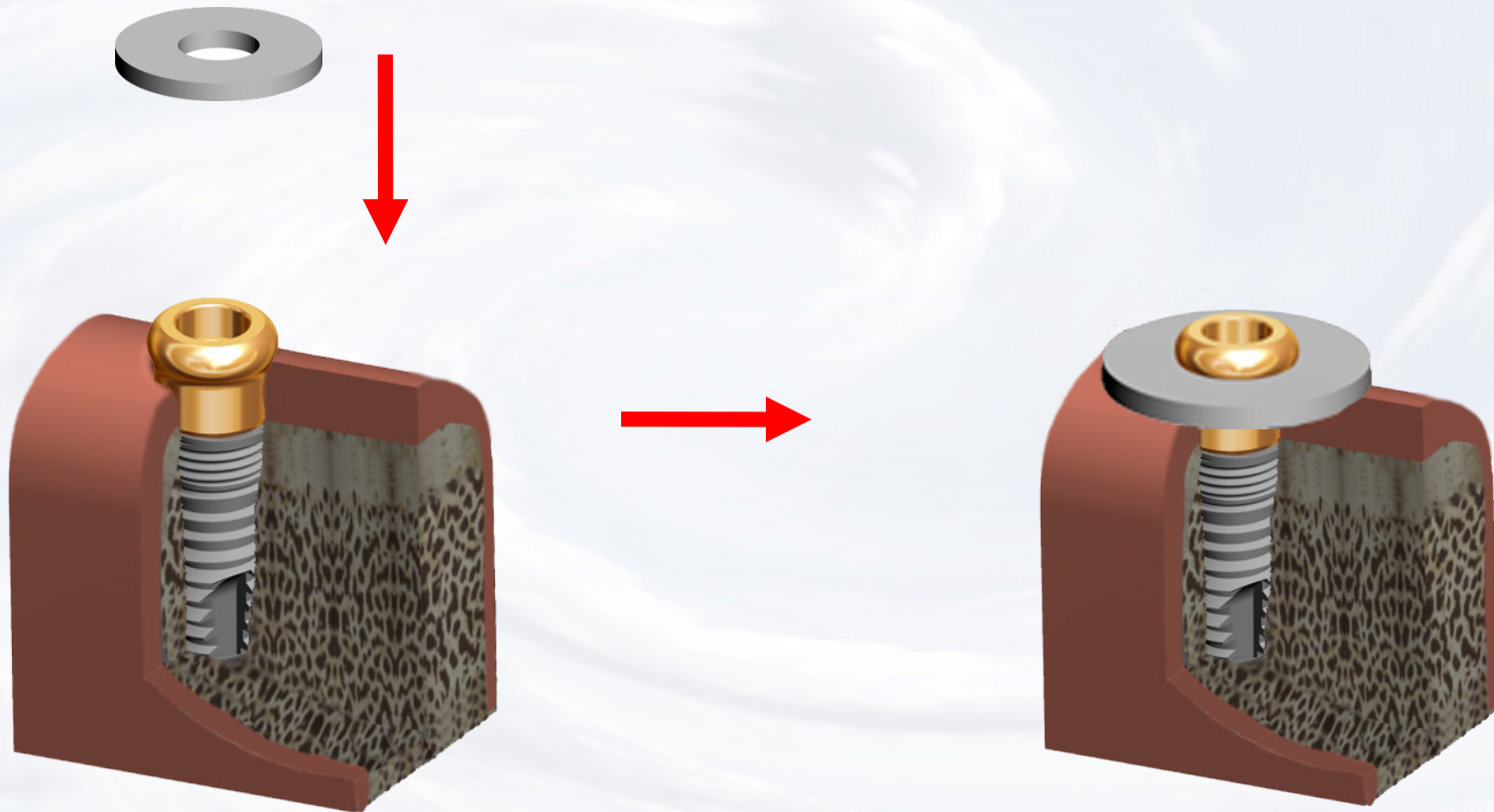

Blue Sky Bio

Overdenture Chairside Technique with Super Snap

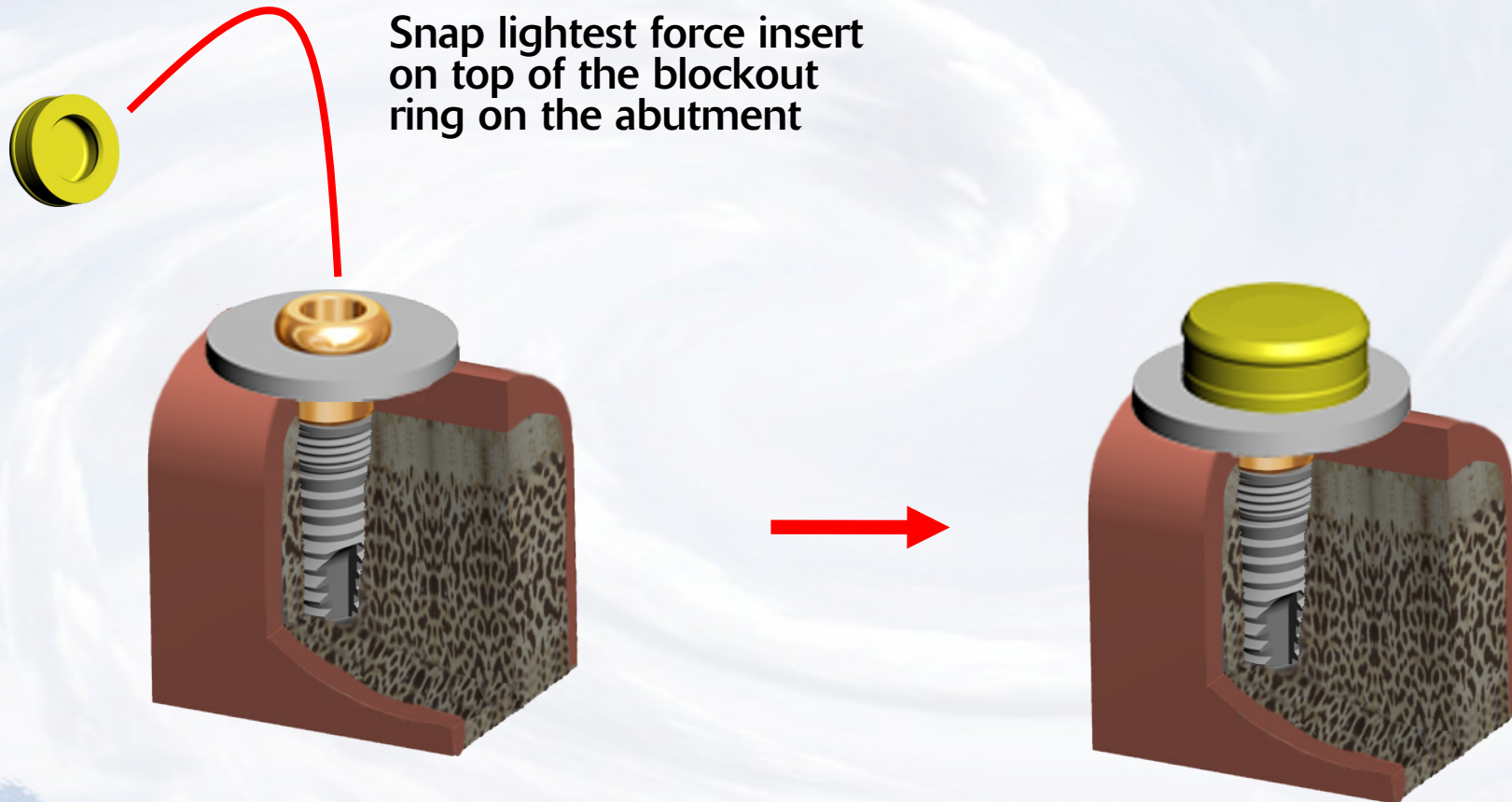

Blue Sky Bio

Overdenture Chairside Technique with Super Snap



Remove enough material from the tissue side of the denture to ensure that it does not interfere with the housings. Typically it is necessary to make the cavity in the denture 2-3mm wider and 1-2mm taller than the housing



Insert denture and ensure that when it is fully seated it does not touch the housings



Blue Sky Bio

Overdenture Chairside Technique with Super Snap



Insert resin of choice into the cavities in the denture



Insert denture again over the housings and with the patient occluding on the denture



Blue Sky Bio

Overdenture Chairside Technique with Super Snap



Let resin cure with denture in appropriate occlusion

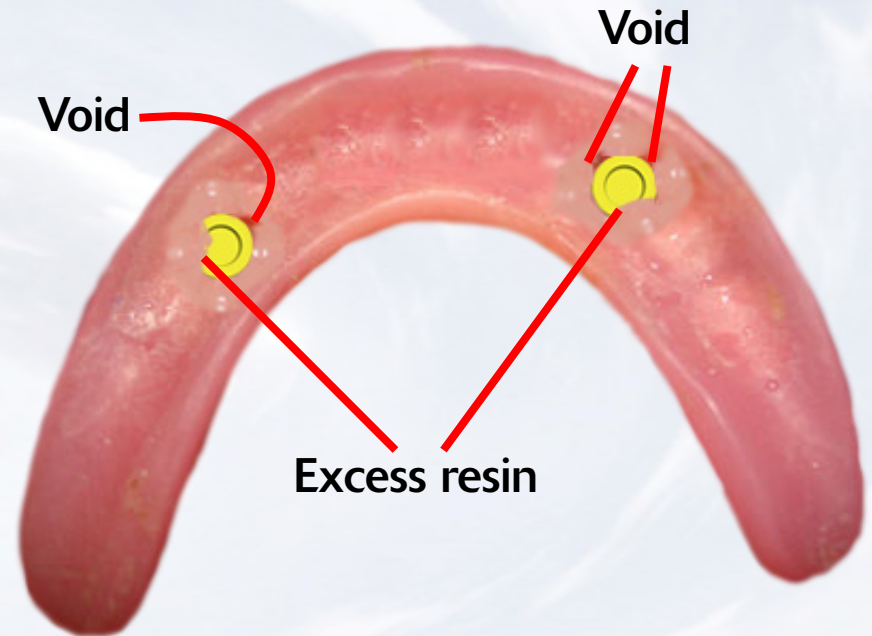

Remove denture from mouth and fill any voids with resin.
Trim any excess resin around the housing and on the ridge area



Blue Sky Bio

Overdenture Chairside Technique with Super Snap



Finished prosthesis with
inserts in place



Blue Sky Bio

Overdenture Chairside Technique with Super Snap (Optional)

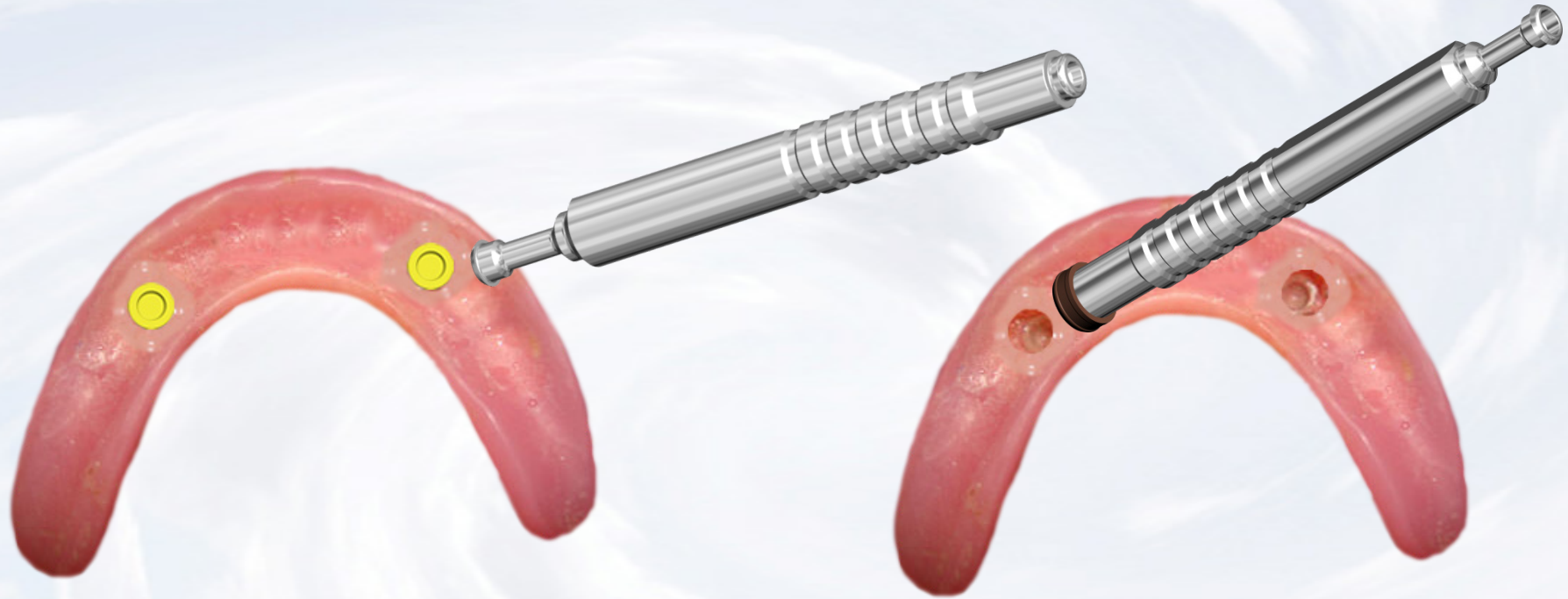

Remove the insert you want to change with the sharp point of the removal instrument

Place the insert with the desired retention into the denture with the opposite side of the removal instrument



Blue Sky Bio